

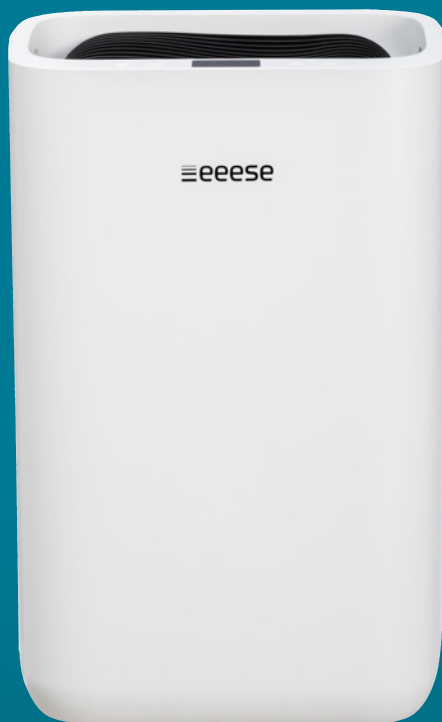

User manual

Dehumidifier Hugo

Art. 2556 & 2557



Thank you for choosing this product.
Please read this instruction manual before using it.



Please read the user manual before any use, refer to the corresponding section in this user manual. Save it for future reference. We reserve the right for any error in text or images and any necessary changes made to technical data.



Recycle unwanted materials instead of disposing of them. All appliances and packaging should be sorted and tendered at a regional recycling centre and be processed in an ecological manner.



The product conforms to the applicable European and other directives.



Table of Contents

1. Safety Instructions	86
2. Parts List	88
3. Continuous Drainage	89
4. Prior to Operation.....	90
5. Operation Instructions	90
6. Cleaning the dehumidifier	95
7. Cleaning the Air Pre-Filter Frame.....	95
8. Storage	96
9. Trouble Shooting.....	96
10. Technical Specifications	98
11. Service	98
12. Warranty	99
13. Responsible Disposal.....	100
14. Warning on Refrigerant R290.....	100
15. Connection to WIFI.....	101

1. Safety Instructions

Warning

This appliance is intended for use in a domestic environment only. Any other use is not recommended by the manufacturer and may cause fire, electrical shocks or other person injury and property damage. Never try to dismantle or repair the machine yourself. The appliance shall be installed in accordance with national wiring regulations. The machine is designed A-weighted sound pressure level below 70dB. Check the voltage and make sure it meets the technical specification of the machine. This machine can be used by children aged from 8 years and above and persons with reduced physical, sensory or mental capabilities or lack of experience and knowledge if they have been given supervision or instruction concerning use of the appliance in a safe way and understand the hazards involved.



Cautions



Wet hands not allowed



Warning

Power Cord

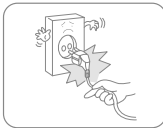

Do not pull the power cord in order to unplug the device from the socket.

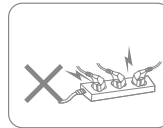

Do not use the appliance in overloaded extension cord.



Do not put any heavy objects on the power cord in order to avoid safety hazard.

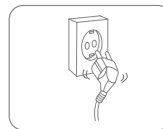

Do not use the appliance if its socket holes cannot firmly hold a plug.



Do not attempt to change the power cord, contact the authorized service center for repair.



Do not touch the plug with wet hands in order to avoid electric shock.

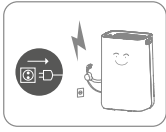

! Unplug the product immediately if it emits strange noises, odours or smoke. Please pull out the plug during lightning storms. Unplug the product when it is not in use.

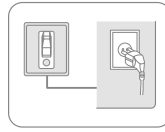

! The socket has to be earthed and appropriately secured.

Placement



Do not put flammable and explosive objects around the appliance in order to avoid fire.

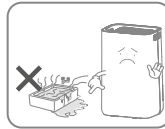

Do not use the appliance in swimming pool or similar facilities in order to avoid safety hazard.

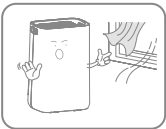

Do not use the appliance in a draughty place or next to a radiator or heating appliance.



Place the appliance on a stable, flat surface. The machine must always stand upright.

During Use

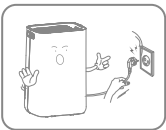

Before moving the dehumidifier please turn off the power, unplug the power cord and make sure that the water tank is empty



Do not pour water into the appliance in order to avoid malfunction.

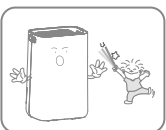

Children shall not play with the machine. Never insert foreign objects into the machine.



Do not put any heavy objects on the appliance in order to avoid malfunction. Never sit on the product.



Do not push the appliance over or let the appliance suffer strong impact in order to avoid malfunction.

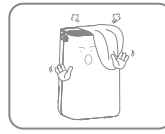

The appliance must not be covered when being used.



Do not put hands on the air outlet in order to avoid injury or malfunction.

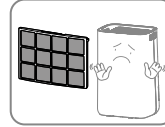

Please install the air filter and make sure it is clean before using it.

2. Parts List

Components

1. Front casing
2. Control panel
3. Air outlet
4. Handle
5. Pre-filter
6. Continuous drainage outlet
7. Water tank
8. Power cord
9. HEPA filter
10. Drain hose

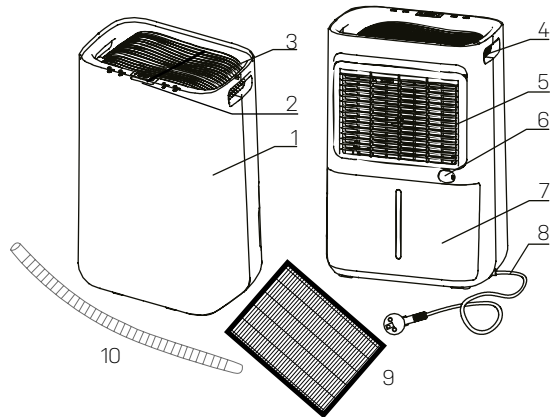



Control panel

11. Mode & Ionizer Button
12. Auto Button
13. Fan Speed & WiFi Button
14. Timer & Child Lock Button
15. Humidity Setting Button
16. Power Button







 Timer Indicator

 Ionizer Indicator

 Air Purifying Indicator

 Sleep Indicator

 Laundry Drying Indicator

 Auto Indicator

 Low Fan Speed Indicator

 High Fan Speed Indicator

 WiFi Indicator

 Childlock Indicator

 Defrosting Indicator

 Tank Full Indicator

Drainage

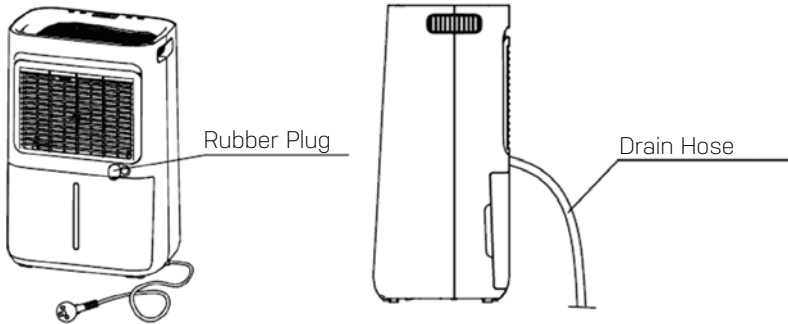

3. Continuous Drainage

Continuous drainage option allows easy removal of collected water instead of manually emptying from the water tank when the environment is very high humidity.

1. Remove the rubber plug covering the drain hose connection.
2. Connect a suitable drain hose (14mm inner diameter) through the drainage outlet. Ensure that the hose is secure and tight to prevent leakage.
3. Always make sure the drainage hose is not blocked or obstructed to maintain a smooth flow.



Please always make sure the pipe is going downhill, and is not blocked or kinked.

4. Prior to Operation

- Check the dehumidifier for any transport damage. In case of damage, you should contact our eeese service line immediately.
- Place the dehumidifier in an upright position on a stable, flat surface.
- Make sure that the mains lead is easily accessible and is not damaged by sharp edges or is crushed in any way during use.
- Ensure the dehumidifier is at a safe distance at least 50 cm away from a wall or furniture and has air space on all sides.
- The machine must stand upright for at least 1 hour before it is used for the first time
- If any part of your house suffers from severe humidity, the dehumidifier can be placed there first and then moved to another part of the house later.
- Ensure the supply power is in correspondence with the value on the nameplate and power outlet needs to be grounded.
- Ensure the water tank is correctly fitted before the dehumidifier can be switched on.
- If the dehumidifier is turned off and then turned back on again immediately, it will take approximately 3 minutes to reach full power (compressor back to work).
- If the dehumidifier is switched off by a power cut, it will automatically switch back on once the power is restored.
- The dehumidifier works best at normal room temperature, its efficiency is reduced if the ambient temperature falls to below 15°C.
- Turn on the power and run the machine as per instructions below.

5. Operation Instructions

Switch On / Switch Off The Unit



1. Connect the mains lead to socket.
2. Press **Power button (A)** once to turn on the unit. By default, it runs on Manual Dehumidifying Mode.
3. Press **Power button** once again to turn off the unit.

Humidity Setting Control



Press the **Humidity setting button (A)** to select the desired maximum level of humidity between the following CO-30%-35%-40%-45%-50%-55%-60%-65%-70%-75%-80%-CO. CO stands for continuous non-stop dehumidification. If you select one of the percentages, then the unit will run until that level is reached. And if the humidity is below the selected percentage, the unit will not run.



If the ambient humidity is lower than 30% the display will show LO



If the ambient humidity is higher than 90% the display will show HI



Timer Setting



When the unit is turned on, press the **Timer button (A)** and select between 1-24hr to select your preferred timer duration before automatic shutoff setting. The timer indicator will be activated on the display.

Fan speed



During normal dehumidification, you can select high or low **fan speed (A)**. This will affect how quickly dehumidifies.

WIFI Function



Press the **Fan Speed button (A)** for 2 seconds to activate the WiFi function and enter into the distribution network mode. During the network configuration, the WiFi indicator (B) flashes and after the WiFi is connected, the icon is on.



See below section Connection to WiFi for detailed settings.

Press the **Fan Speed** button for 2 seconds and you can disconnect to the WiFi.

Auto Dehumidification



Press the **Auto** button (A) to enter into the Auto Dehumidifying Mode, the unit runs automatically accordance to the ambient humidity detected below.

Ambient RH% detected	Compressor	Fan Speed Level
RH%>65%	Working	High
55%≤RH%≤65%	Working	Low
RH%<55%	Stops Working	Low

RH = Relative humidity

Sleep Mode



Press the **Mode button (A)** until the **Sleep mode** indicator (B) shows on the display. 10 seconds later, all indicators will be off. At Sleep mode, it operates on low fan speed.



At **Sleep mode**, press any button to wake up the unit and then you can operate the unit as usual.

Air Purifying Mode



Press the **Mode Button** (A) until the Air Purifier and Ionizer indicator (B) shows on the display (B). The unit works with high fan speed without dehumidifying, it will only purify the air.



The ionizer function can be turned off by pressing the Mode button for 2 seconds.

Built in Ionizer



The ionizer creates negative ions that attach to positive charged molecules such as dust, bacteria, pollen, smoke, and other allergens. These molecules attach to each other into bigger molecules that cannot float in the air and falls to the ground.

Press the **Mode** button (A) for 2 seconds to activate the ionizer function. The ionizer indicator will show on the display once activated (B). Inactivate it by pressing the **Mode** button for 2 seconds again. Note that the ionizer indicator disappears.



If the fan stops working, the ionizer function will automatically be deactivated.

Safety Childlock Function



To prevent the mishandling by young children, the unit is equipped with a childlock function. Press **Timer button (A)** for 2 seconds to activate or deactivate the childlock function. The child lock indicator will be activated on the display (B).

Automatic Shut Off



When the water tank becomes full during normal use, the unit shuts off automatically with **Full tank indicator (A)** on the screen and buzzer alarm goes off for 5 times.



If water tank is removed or not placed properly, the above described will occur.

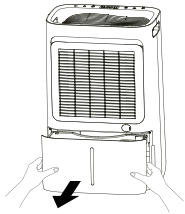

A - Pull the water tank out

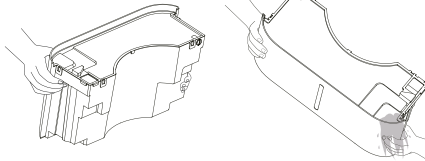

B - Pour out the water

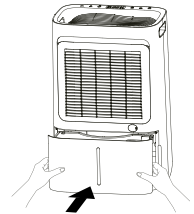

C - Push the water tank back again

Automatic Defrost Feature



The unit is equipped with an automatic defrost feature. When room temperature is too low, the compressor shuts off and the unit will run on high fan speed until the frost has disappeared. No settings can be made while the defrost indicator is on (A).

Memory Feature

When power failure and after recovering, the unit will work with the mode prior to the shutdown. Means the timer setting, humidity setting and working mode setting will be kept.

6. Cleaning the dehumidifier

When used regularly, the filter may become clogged with dust and particles. To ensure the effectiveness of the dehumidifier, it is recommended to clean the unit at least every two weeks:

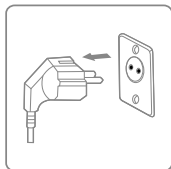

Switch the device off and remove the plug from the socket before cleaning.



Clean the housing with a soft, dry cloth. Vacuum clean the air inlet and outlet grilles of the dehumidifier. If the device is extremely dirty, use a mild cleaning agent. Wipe the dehumidifier with a slightly damp cloth. Remove the water tank and wash it by hand using a mild detergent. Rinse it with clean water.

Note: Do not spray water directly onto the unit.

Cleaning and user maintenance shall not be made by children without supervision.



The **HEPA** filter cannot be cleaned and needs to be replaced once a year.

7. Cleaning the Pre Filter Frame

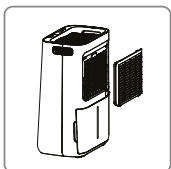

1. Remove the inlet frame from the back.
2. Wash the pre-filter frame carefully in warm water, use a mild detergent if necessary.

Note: DO NOT wash the pre-filter frame in a dishwasher.

3. Rinse the pre-filter frame in clean water and let it dry before reinserting it.
4. Fit the pre-filter frame back onto the unit.

Note: DO NOT use the dehumidifier without the pre-filter frame in place.

8. Storage

If the dehumidifier will not be used for a long period of time, take the following steps:

1. Remove the plug from the socket and empty the tank, make sure the tank and the dehumidifier is completely dry. This may take a couple of days.
2. Clean the air filter.
3. Check the dehumidifier for perfect condition to ensure a safe use of it after a long period of storage.
4. Pack the device with the suitable packaging.
5. Store the dehumidifier in a dust-free location, and out of direct sunlight. Preferably covered with a sheet of plastic.

9. Trouble Shooting

Check the following before contacting technical support:

PROBLEM	POSSIBLE CAUSE	SOLUTION
The dehumidifier will not switch on	The power is not connected	Insert the plug into the wall outlet
	The water tank is full	Empty the tank
	The tank has not been replaced correctly	Replace the tank
	The set humidity level has been reached.	Lower the humidity level
	Power plug or cord damaged	Contact an authorized service centre for repair
Water removal capacity is too low	Runtime is too short	Be patient and wait
	Ambient temperature or humidity is too low	It is normal that the device does not dehumidify in these conditions
The device works, but reduces the relative humidity insufficiently	The room is too big	We recommend using a dehumidifier with a greater capacity
	There is too much ventilation	Reduce ventilation (e.g. close windows and shut doors)
	The pre-filter is clogged	Clean the pre-filter
	Set humidity is higher than the ambient humidity	Set the humidity lower than ambient humidity

The humidity is not reducing	The dehumidifier has not been used long enough.	Be patient and wait
	The ambient temperature is too low	Reduce the ambient temperature
	The surrounding humidity level is too low	This is normal. You can doublecheck with a hydrometer
	The ambient humidity level is lower than the desired humidity level set	This is normal. You can doublecheck with a hydrometer
	The air filter frame is dirty	Clean the pre -filter frame
Dehumidifier is blowing out warm air	The dried air is passed over heating coils before it is blown into the room as part of the dehumidifying process	This is normal, a dehumidifier is not an air cooler
Water on floor	There is residual water in tank, and the device is lurched too much by moving	Be careful when moving the tank
Water in tank overflows	The water tank may be damaged	Contact our eeese service line
	Float for water auto-sensor is not in place Internal drainage passage is blocked or obstructed	
The dehumidifier is noisy	The pre-filter is blocked or the device is on an uneven surface	Clean the pre-filter or put the device on a flat surface
Error code	E1: Temperature sensor error E2: Humidity sensor error	Contact our eeese service line

10. Technical Specifications

Model Hugo Art. no		2556	2557
Max. working area m ²		100	120
Recommended working area m ²		4-70	4-85
WiFi		Yes	Yes
Timer, h		1 ~ 24	
IP code		IPX4	
Power Supply		220-240V - 50Hz	
Dehumidifying Capacity (30°C RH 80%), L/day		20	25
Dehumidifying Capacity (27°C RH 60%), L/day		12	15
Power Consumption, W		245	290
Air Volume m ³ /h	High	190	
	Low	160	
Noise Level dB(A)	High	44	44
	Low	40	42
Water Tank Capacity, L		4.5	
Operating Temperature, °C		5~35	
Refrigerant		R290 / 0.068kg	R290 / 0.075kg
Compressor		Reciprocating	
Net Weight, kg		14.9	15.6
HEPA filter included		Yes	Yes
Pre-filter		Washable	
Drain Hose Diameter mm		14	
Drain hose included		Yes	
Product Size (HxWxD), cm		58 x 37.8 x 27.3	

The above technical data are for reference only. We reserve the right to modify them without notice.

11. Service

If you have any questions or need more information, please feel free to call

eeese customer service on +45 69 16 32 00

If you need service or to make a warranty claim, you must create a case directly in our support system. Go to the website under SUPPORT.

12. Warranty

Limited warranty

We guarantee that all parts are free of defects in materials and workmanship for a period of two years from the date of purchase. The warranty covers only material or manufacturing defects that prevent the product from being able to be installed or operated in a normal way. Defective parts will be replaced or repaired.

The warranty does not cover transportation damage, any use other than what is intended, damage caused by incorrect assembly or improper use, damage caused by impact or other error, or by improper storage.

The warranty becomes void if the user modifies the product.

The warranty does not include product-related damage, property damage or general operational loss.

The manufacturer's liability cannot exceed the repair or replacement of defective parts and does not include labour costs to remove and reinstall the defective part, transportation costs to and from the service center, and all other materials necessary to carry out the repair.

This warranty does not cover failure or malfunction as a result of the following:

- Lack of proper installation, operation or maintenance of the unit in accordance with our published "User's Guide" supplied with the unit.
- The workmanship of any installation of the unit.
- Misuse, alteration, accident, fire, flood, lightning strike, rodents, insects, negligence or unforeseen events.
- Use of non-factory authorised parts or accessories in conjunction with the product.

Limitation of liability

This is the only warranty provided by the manufacturer. No one is authorised to make any other warranties on our behalf.

This warranty is in lieu of all other warranties, expressed or implied, including but not limited to any implied warranty of fitness for a particular purpose and saleability. We expressly disclaim all liability for consequential damage, accidental damage, indirect loss or loss related to a breach of the expressed or implied warranty.

This warranty gives you specific legal rights, which may vary by country.

Complaints

In the event of any warranty claim a valid purchase receipt must be presented. Read about raising a warranty-claim under the SERVICE section.

IMPORTANT!

If you need technical help – contact our service line:

eese DK-telephone +45 69 16 32 00

We have specialist knowledge of our products and the field in general, so you can get help quickly and easily.

13. Responsible Disposal

This symbol indicates that this product should not be disposed of with general household waste. This applies throughout the entire EU. In order to prevent any harm to the environment or health hazards caused by incorrect waste disposal, the product must be handed in for recycling so that the material can be disposed of in a responsible manner. When recycling your product, take it to your local collection facility or contact the place of purchase. They will ensure that the product is disposed of in an environmentally sound manner.



14. Warning on Refrigerant R290

The machine is designed only for use with R290(propane) gas as the designated refrigerant.

Note: The refrigerant loop is sealed. Only a qualified technician should attempt to service.

The lack of smell does not indicate a lack of escaped gas. No open flames, cigarettes or other possible sources of ignition should be used in the vicinity of the machine. Component parts are designed for propane and non-incentive and non-sparking. Component parts shall only be replaced with identical repair parts.

Note: The machine may only be installed in a room with a minimum floor area of 4m².

R290 is a flammable gas that is heavier than air. On this basis, if the gas leaks from the unit, the concentration will be the highest at ground level. However, the gas can be lifted (e.g. by draught, fan, etc) to higher levels. The R290(propane) used in this unit has no odour. Do not use the machine in a room with an open flame, other high-level heat sources (e.g. cigarettes, candles, etc.) or electrical discharges. Install the machine in a room which can be ventilated when necessary and where gas accumulation is not possible.

If R290(propane) is detected in the room, or a leak is suspected, do not allow unauthorized persons to search for the source of the leak. In such cases, evacuate all people from the room, open the windows, leave the room and notify your local fire department to advise them that a propane leak has occurred. Do not allow any person to return to the room until the commanding officer of the fire department or a certified service engineer decides that the risk has ceased to exist.



15. Connection to WIFI

App binding device

Search for the App **TuyaSmart** or scan the following QR code for downloading the APP.



Step 1

Make sure your phone is connected to your WIFI at home, and turn on Bluetooth. Tap the **+** in the upper right corner of the home page to add the device.

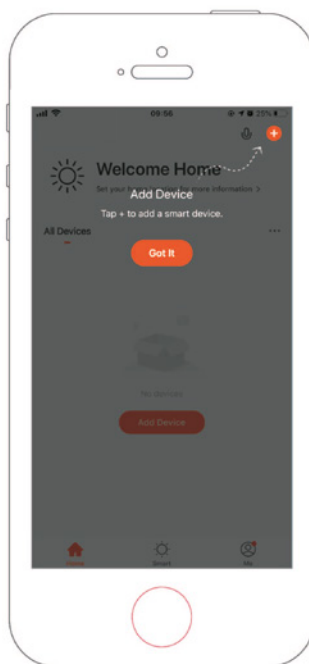

Step 2

Follow the guide to select the device to be configured and then enter the WIFI password.

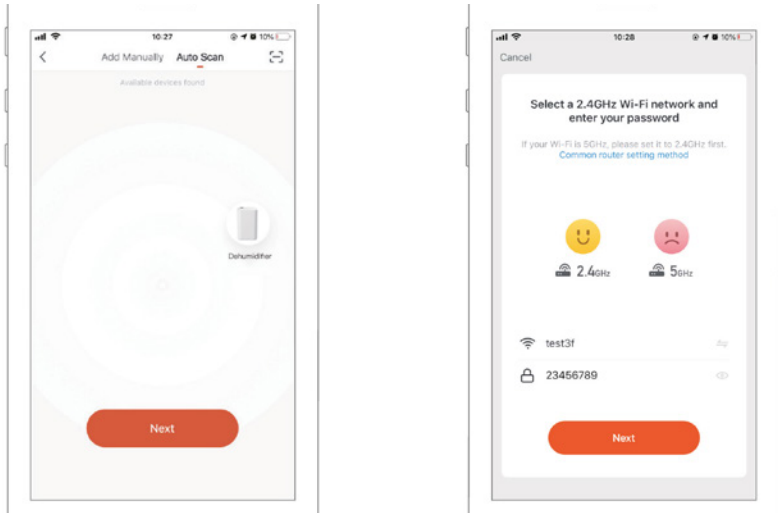

Step 3

Complete the connection to set the dehumidifier with the App.

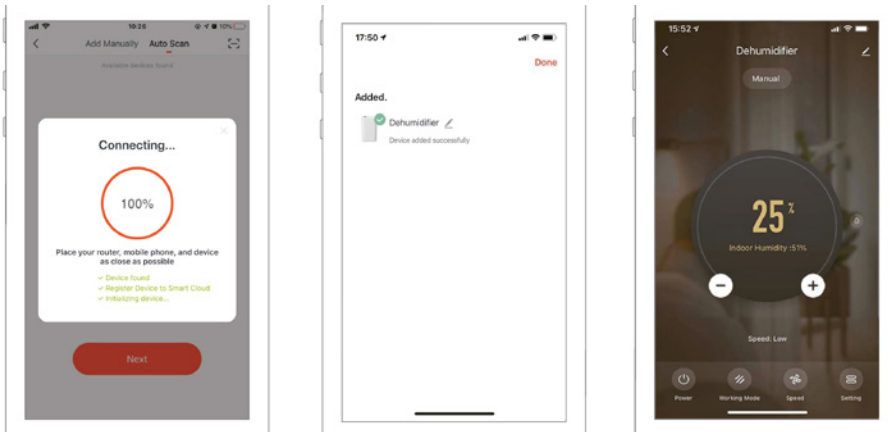

Adding device manually

Step 1

Tap **Add Device** on the home page or tap the **+** in the upper right corner, to go to the Add device page.

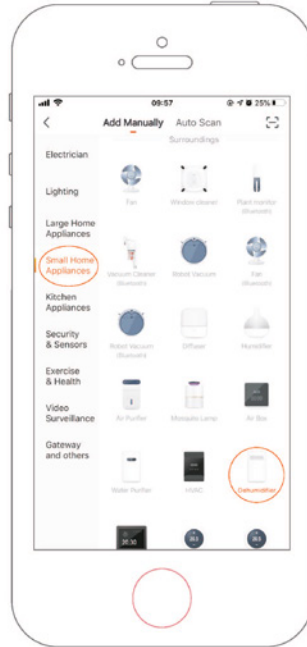
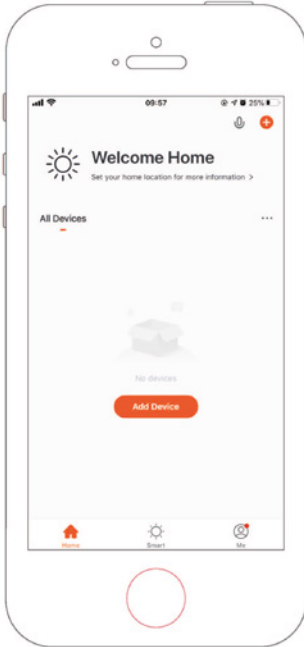

Step 2

Confirm the indicator rapidly blink and enter the WIFI password.

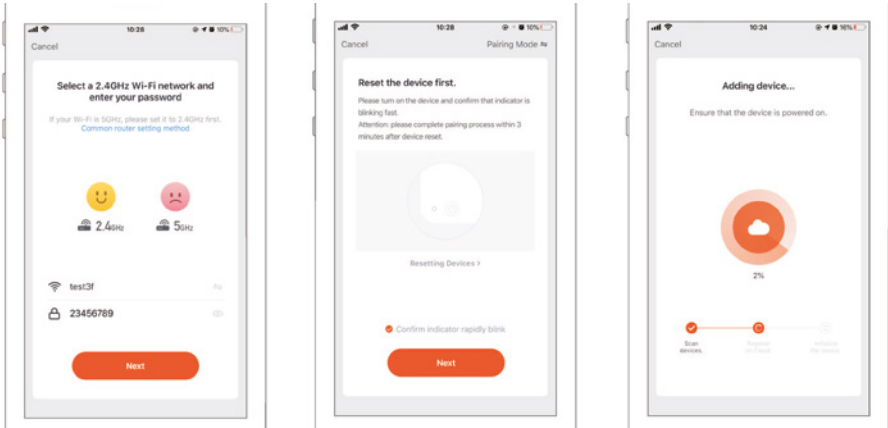

Step 3

Complete the connection to set the dehumidifier with the App.

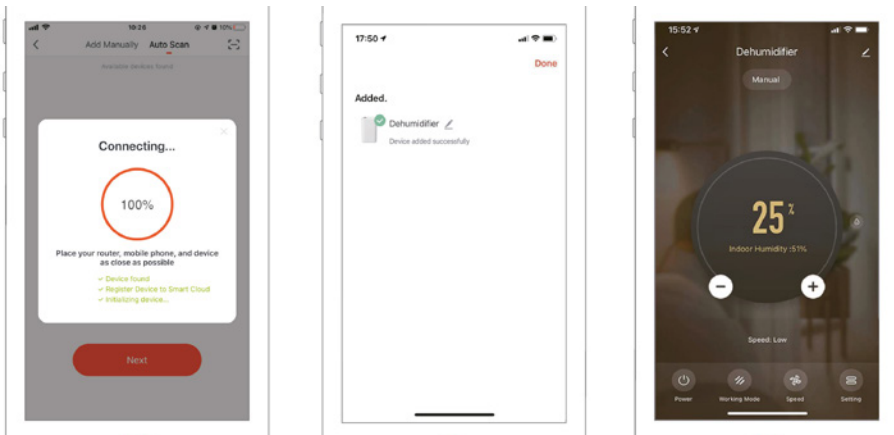



Thank you for choosing this product.
Please read this instruction manual before using it.